A decorative graphic in the top-left corner consists of several overlapping squares in blue, orange, teal, and yellow. Below this graphic is a solid green horizontal bar that spans the width of the slide.

## Belmont Community Path – Public Information Meeting

July 16, 2020

Building better communities with you



# Agenda

- 1. CPPC Introduction**
- 2. Project Update**
- 3. Presentation of PROGRESS 25% Design Plans**
- 4. Next steps for the project**
- 5. Opportunities to provide feedback**

# Project Area



# Project Update: Progress Report

## Progress Report:

- **Feasibility Study for the Belmont Community Path submitted to the Town and CPAC in November 2017**
- **Project accepted by MassDOT in July 2018**
- **Conceptual Design Report (CDR) submitted to Town, MassDOT and MBTA on February 6, 2020**
- **Meeting with MBTA and MassDOT on March 9, 2020**
- **Boring Plans Prepared for Underpass and Retaining Walls and submitted to MBTA**
- **Borings for Underpass Completed**
- **Borings for Retaining Walls on MBTA Property – Waiting for MBTA Access Permit**
- **Anticipated 25% Design Submission to MassDOT - Summer/Fall 2020**

# Project Update: Design Schedule

Design Task	Scheduled Timeframe
Concept Design Report (Reviewed by MassDOT & MBTA)	February 6, 2020
Public Information Meeting & Input	July 16, 2020
Submit 25% Design to MassDOT	Summer/Fall 2020
MassDOT Review of 25% Design	Fall/Winter 2020
Design Public Hearing	Winter 2020
75% Design Submission	Spring 2021
100% Design Submission	Fall 2021
Ready to Advertise for Construction	Winter 2021
Anticipated Construction Start	TBD*

\*Construction Start dependent on MPO Funding availability

# Project Update: Stakeholder Meetings

Stakeholder Meetings (until March)	Dates
Belmont Historic District Commission	11/7/2019
Belmont Middle and High School Building Committee	11/7/2019
Historic Commission	11/7/2019
Channing Road Neighborhood/Abutter Site Walk	11/16/2019
Belmont Department of Public Works	11/18/2019
Belmont Fire Department	11/18/2019
Belmont Middle and High School Building Committee	11/19/2019
Belmont High School and School Committee	11/20/2019
MBTA / MDOT meeting	3/9/2020

# Project Update: Public Engagement/Outreach

## Engagement Means (& opportunities for feedback):

- Project Website Updates ([www.belmontcommunitypath.com](http://www.belmontcommunitypath.com))
- Comment on designs & provide feedback via survey
- Public Meetings (today & MassDOT Design Public Hearing in the fall)
- Abutter Site Walk
- Call for Art

## Belmont Community Path

[Home](#) [Project Updates](#) [Project Background](#)



The intent of this site is to share key information about the Belmont Community Path project, its status, upcoming meeting dates, and opportunities for engagement. Stay tuned for more information!

If you'd like to receive automatic updates when new information is posted, please subscribe via the mini-form in the sidebar.

**Subscribe for Updates**  
Name\*   
Email\*

# Opportunities to engage today and in the future

There are several means to **provide feedback today and over the next few weeks:**

- View and comment on the 25 % Progress Plans on the project website at [www.belmontcommunitypath.com](http://www.belmontcommunitypath.com)
- Provide comments during the 2<sup>nd</sup> portion of today's meeting (raise hand if you want to speak)
- Respond to survey open until 07/31 available at [www.belmontcommunitypath.com](http://www.belmontcommunitypath.com)
- Student group involvement to discuss the Path
- Get creative in the **Call for Art!**



The screenshot shows the Belmont Community Path website. At the top, there is a green header with the site name "Belmont Community Path" in white. Below the header is a navigation menu with links for "Home", "Project Updates", and "Project Background". The main content area features a map of the project area with a red line indicating the path. The map includes labels for "Channing Rd", "Alexander Ave", "Pleasant St", "Clark St", "Common St", "Underwood Playground", "New Belmont Middle & High School", "Clay Pit Pond", "Concord Ave", "Brighton St", and "Cambridge". Below the map, there is a paragraph of text: "The intent of this site is to share key information about the Belmont Community Path project, its status, upcoming meeting dates, and opportunities for engagement. Stay tuned for more information!" followed by a call to action: "If you'd like to receive automatic updates when new information is posted, please subscribe via the mini-form in the sidebar." Below this is a section titled "We Welcome Your Feedback on the 25% Draft Project Submittal Plans" with the text: "We are excited to share the latest progress plans for the path and welcome you to share your comments with us by participating in a brief community survey!". At the bottom of this section are two buttons: "25% Belmont Community Path Progress Design Set" and "Community Feedback Survey". On the right side of the page, there is a search bar, a "Subscribe for Updates" section with a "Name\*" field, an "Email\*" field, and a "Subscribe" button. Below this is a paragraph of text: "After you sign up to receive updates, please check your email (including your spam/junk folder) to make sure you have received the confirmation. Add our email address to your contact list/address book to make sure that you receive each update going forward!". At the bottom right, there is a "Visit the Town Website" section with the text: "Belmont Community Path Project Committee (CBCP)".



# Opportunity to Engage: Call For Art

The Belmont Community Path Project Committee is seeking artwork for a project logo to be used on various materials throughout the project. All entries will be acknowledged on the path project website. Students are encouraged to submit art - individuals or groups! What's your vision?!



*When can I submit artwork?*

**Deadline Extended!**  
*Submissions will be accepted in  
an ongoing manner*

*Can I submit something I have already made?*

**Yes!** An existing artwork – photo, design, painting, drawing, or collage – that you think connects to the project, please submit! Be sure your digital submission is a good representation of the original work and keep the original artwork available, in the event that it is selected.

*Example of earlier logo, CPAC 2012*

*How to submit?*

- 1) Complete this form:  
<https://forms.gle/sae4peu5WzZ3czkn8>
- 2) And email an image of your work to:  
[pathcommitteelogo@gmail.com](mailto:pathcommitteelogo@gmail.com)

*Questions about Phase 1a and 1b of the Community Path?*

Go to <https://belmontcommunitypath.com/>



*The community path will close the gap  
between Waltham and Cambridge.  
(photo courtesy of Nitsch Engineering)*

# What we heard: Abutter Site Walk on 11/16/19

Join Abutters & Nitsch Engineering for:

## Belmont Community Path Abutter Site Walk



**WHEN** Saturday, November 16th from 9am-2pm  
(rain date: November 23rd).

**WHO** Abutters to Proposed Belmont Community Path & Representatives from Nitsch Engineering

**WHERE** Meet us for the whole walk or a portion.

9 – 10 am: 17 Channing Road  
10:30 – 11:30 am: At the crossing of 159 Alexander Ave & Channing Rd  
1 – 2 pm: 321 Channing Road

**WHY** Join us along the walk to give feedback, ask questions and learn more about ways to get engaged in the design process of the Phase 1A (Alexander Ave Underpass) and Phase 1B (Brighton St to Clark St Bridge) of the new Belmont Community Path.

*\*For safety reasons, we will not be walking along the train tracks. We will walk along Channing Road instead.*

**LEARN MORE:**

<https://belmontcommunitypath.com/>  
or contact John (jnichalak@nitscheng.com), Isabel (ikaubisch@michalak@nitscheng.com) or Becky (brupel@copley-wolf.com)



## Goals / Purpose:

- Learn about concerns and discuss opportunities to meet needs (within project scope)
- Engage abutters by discussing design opportunities, such as:
  - materials and screening etc. used in backyards;
  - drainage solutions
  - potential connections to path and specific destinations in town



French-Mahoney Property  
(11/16/19 site walk attendees)

# What we heard: Abutters & Students

Abutter Concerns	Potential Solutions
Privacy	Vegetation and/or screening
Security	Vegetation and/or Screening
Noise	Vegetation (preserve current trees)
Drainage Issues	To be addressed during 25% design
Parking at Alexander Ave Underpass	Prohibit parking near underpass

Student Concerns / Comments	Potential Solutions / Next Steps
Different levels of skilled ridership and users of the Path	Awareness & Education
Opportunity to install art i.e. at proposed Alexander Ave Underpass	Student Group to create design contest or similar



Proposed Alexander Ave Underpass Location

# Feedback on 25 % Progress Designs

## Widening of Path (6)

- Widen path around sharp turns to help cyclists maneuver safely
- Preferred width of 16'

## Traffic & Safety (4)

- Traffic impacting school drop-offs and pick-ups at the underpass
- Slowing down fast cyclists on the narrow portions of path to protect young children?
- Does Alexander Ave allow access for emergency or maintenance vehicles and can it?
- Concerns about how additional crossings will impact traffic in Belmont Center

## Privacy, Screening, & Lighting (5)

- Issues with large artificial barriers & chain link fences
- Very Important for abutters to be adequately screened with vegetation
- Apprehensions regarding bright lights in backyards
- Harsh barrier along parking of 40 Belmont, and desires something softer

## Concord Ave Connection (4)

- Major concerns about sharp turns at connection with Concord Ave
- Nervous that the path will end up on this road instead of adjacent to the rail

## Clark St & Spur (4)

- Potential for crashes at intersection of the Path and Clark Street due to the 4.5% slope with a sharp turn at the bottom
- Suggestions to straighten the curve
- Questions about ADA accessibility and snow removal

## Brighton St Intersection (2)

- Safety at the intersection
- Considerations for an overpass instead

## Parks & Landscape (2)

- Disappointment over lack of park-like landscapes as shown in concept sketches
- Hoped that route would use and connect town parks as a welcoming and scenic route

## Miscellaneous Concerns (4)

- Distress about the lack of abutters as representation on the committee of stakeholders
- Strong desire for personal path access
- Snow/drainage concerns

A total of 37 respondents commented (07/13/20).

# Belmont Community Path – Survey Response 3 & 5

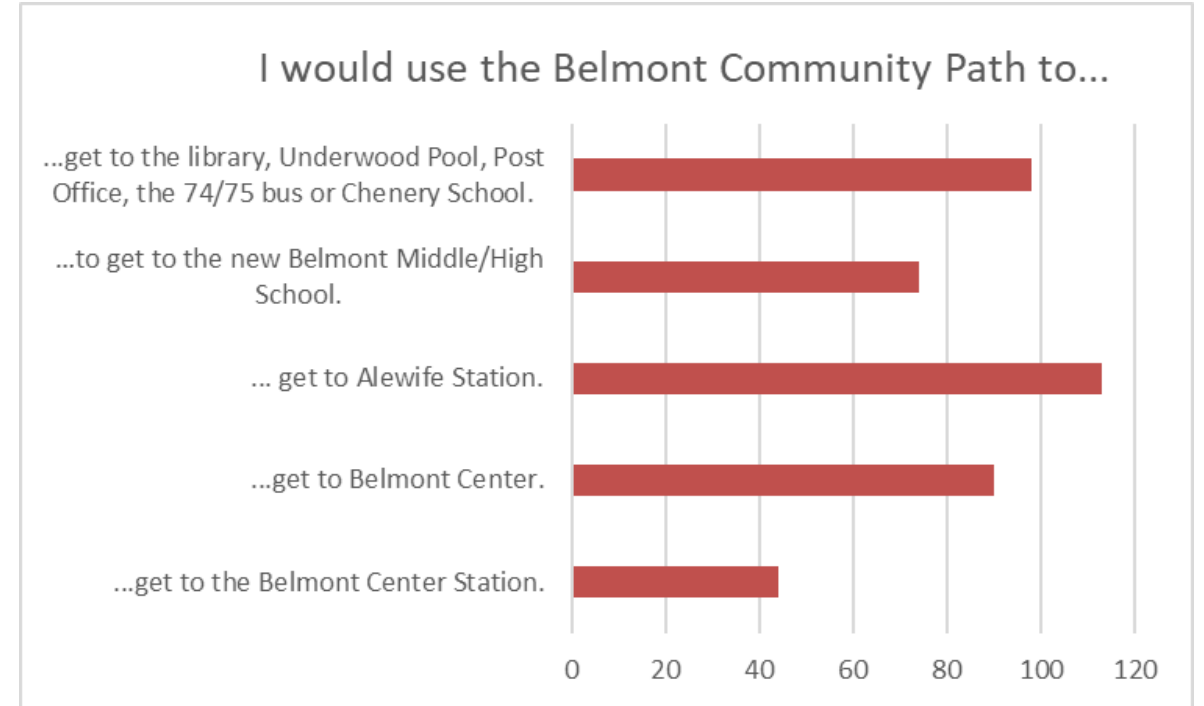
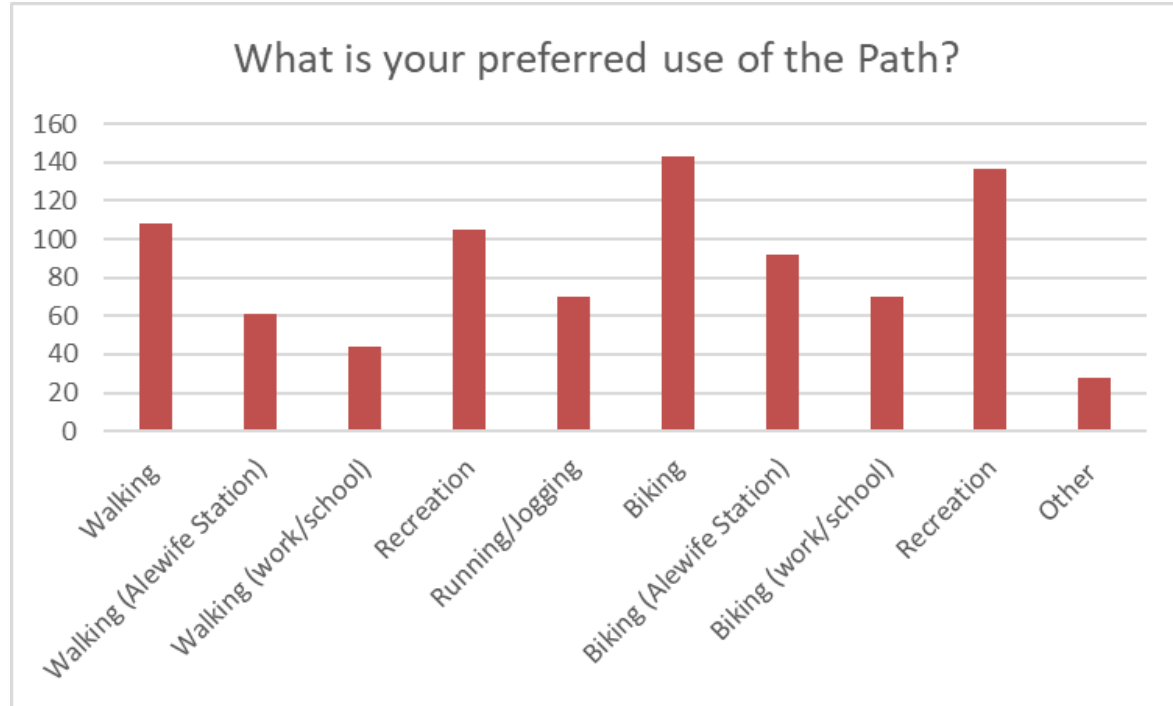

A total of 170 (Q 3) and 169 (Q 5) respondents answered this question (07/14/20); multiple choices given.





# Typical Path Segment

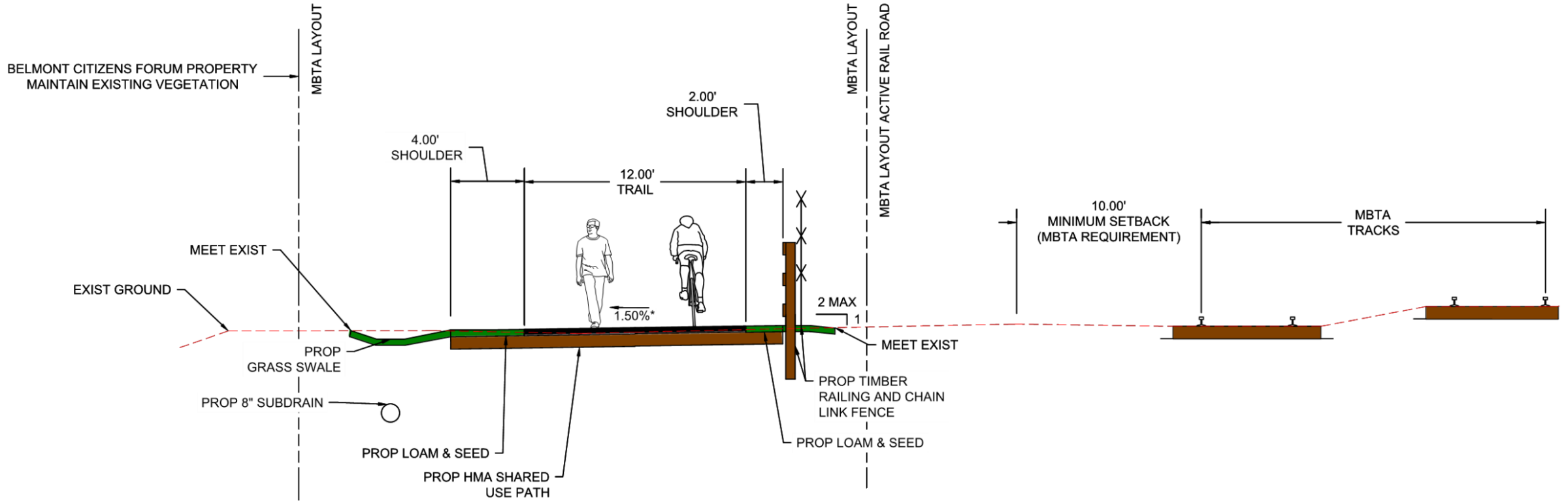





# Clark Street / Pleasant Street Connection

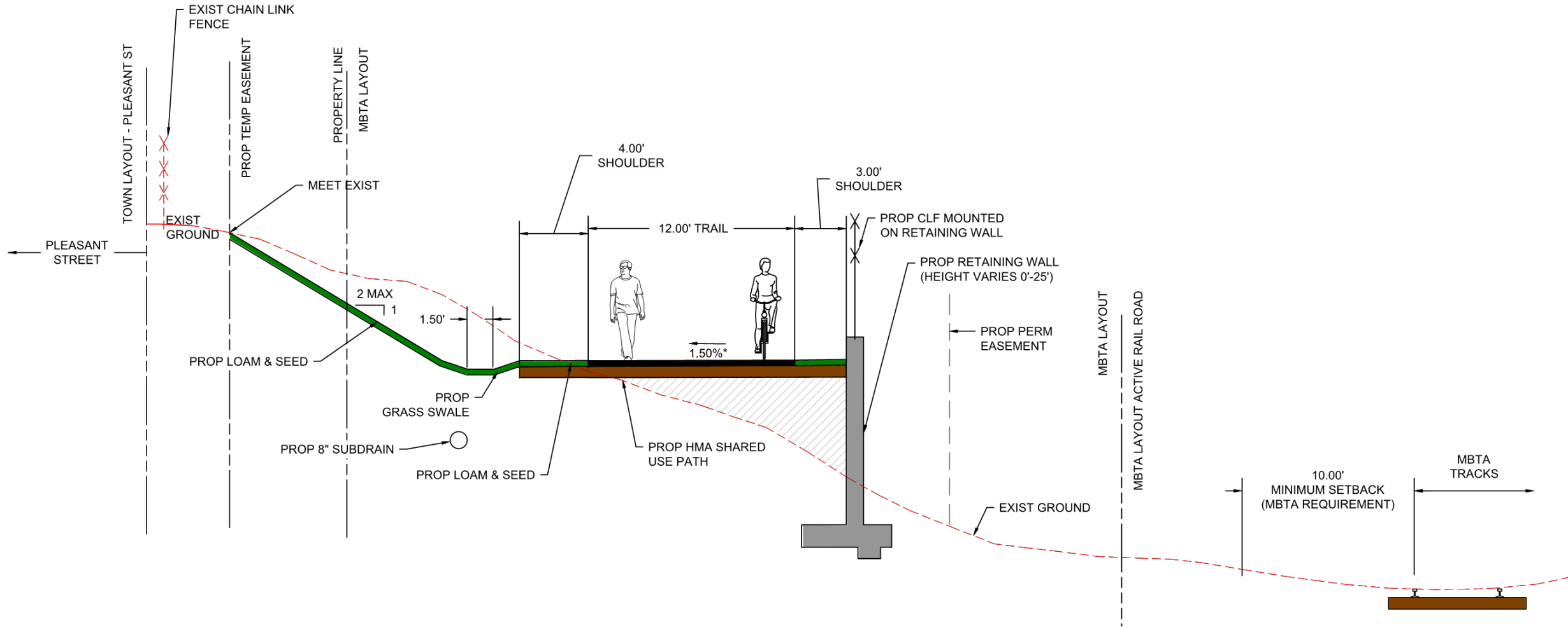

# Belmont Community Path – Clark Street Connector



Plan: Clark Street Connector Area

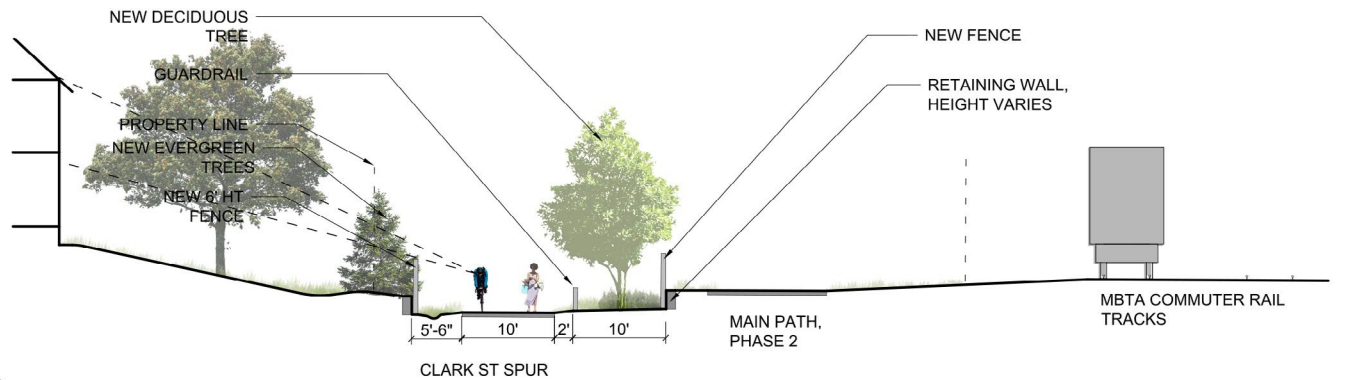

SECTION 1: 721 PLEASANT STREET  
SCALE: 1" = 10'-0"



# Concord Ave Connection at Belmont Station

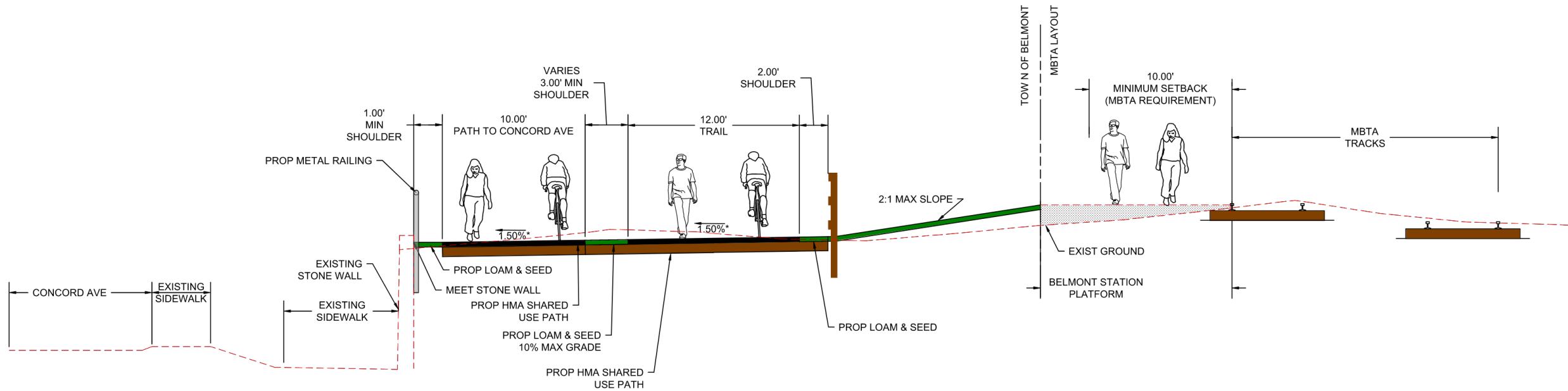

# Belmont Community Path – Belmont MBTA Station



Site Plan: Belmont MBTA Station

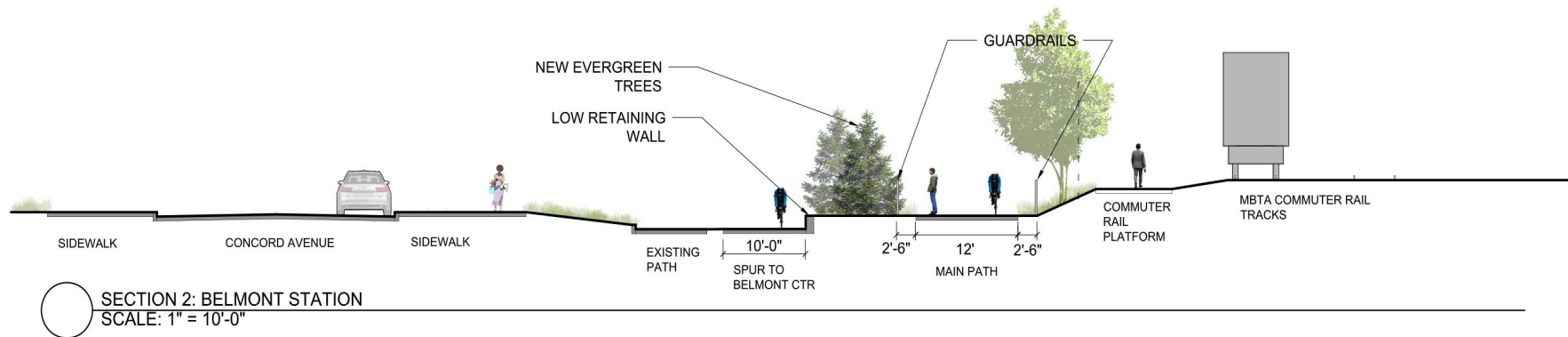

# Concord Ave Bridge and #7 Channing Road

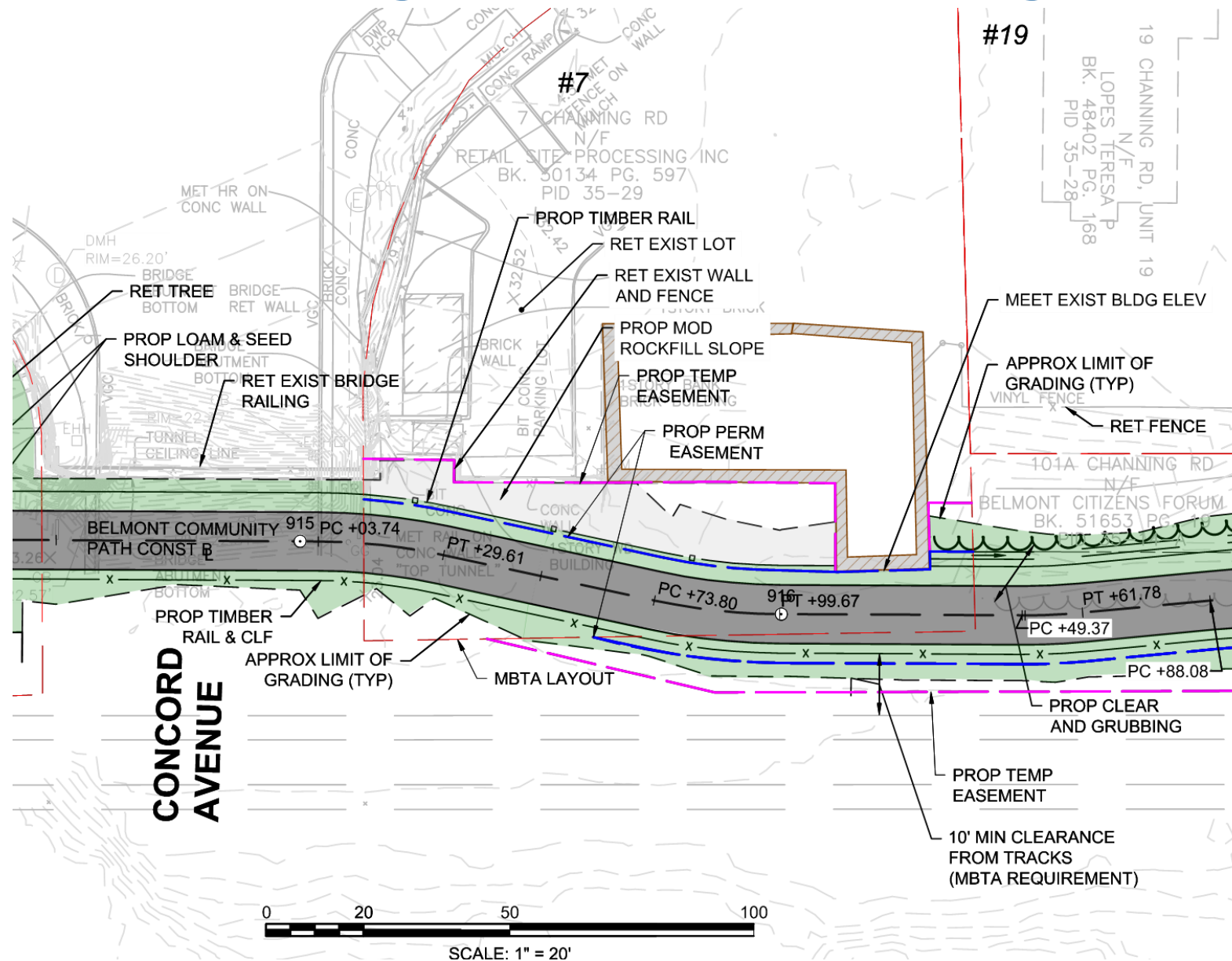

# Concord Ave Bridge and #7 Channing Road

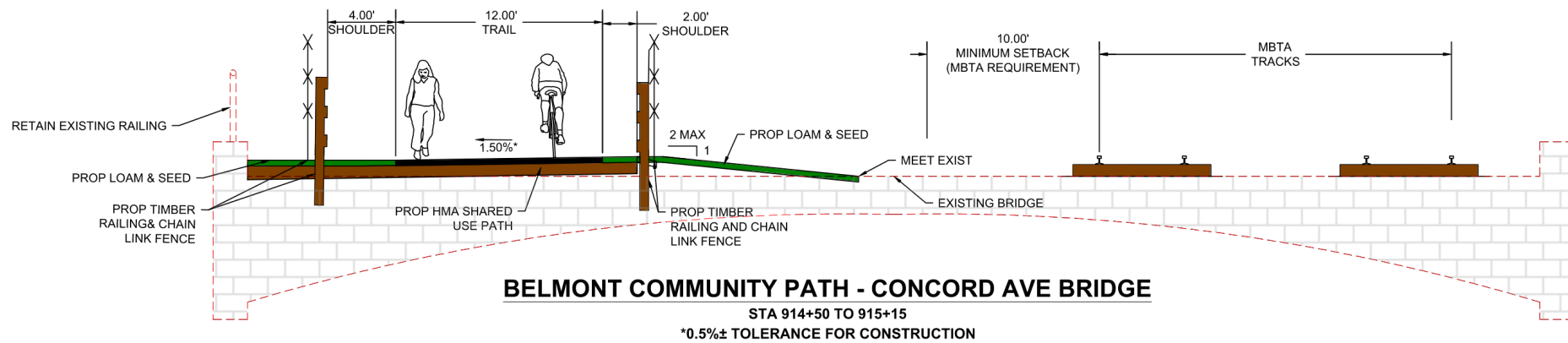
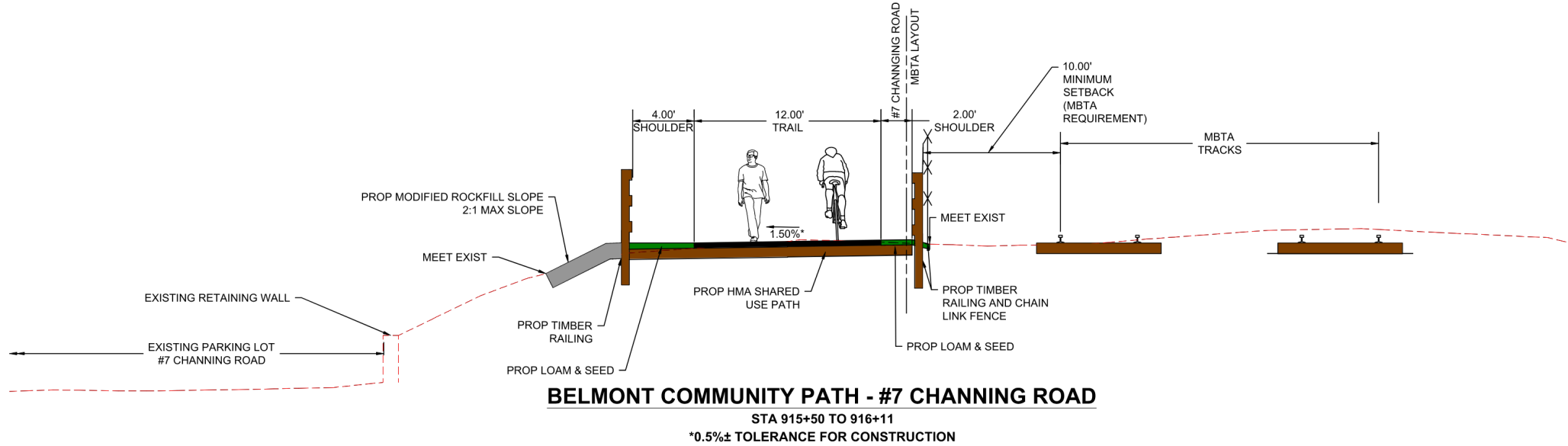



# Concept Study for Path Connections on East Side of Bridge

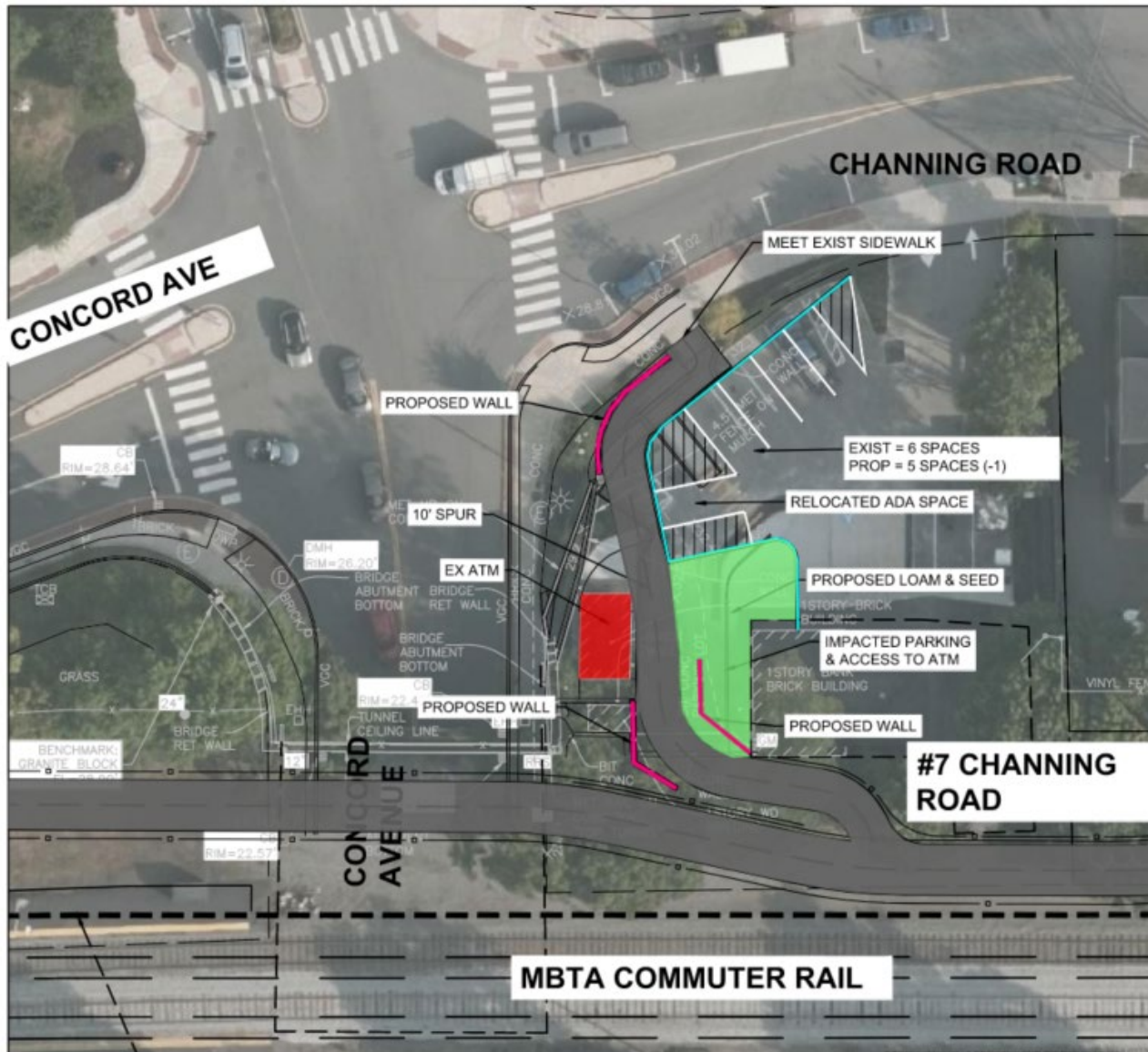

## West side of #7 Channing Road

- Connecting path would have 9% slope  
Slope is greater than 5% maximum allowed by ADA
- Remove parking stalls
- Reduced parking lot
- Limited access to ATM
- Additional retaining walls required



# Path Segment Between Concord Ave and Brighton St

## CHANNING ROAD

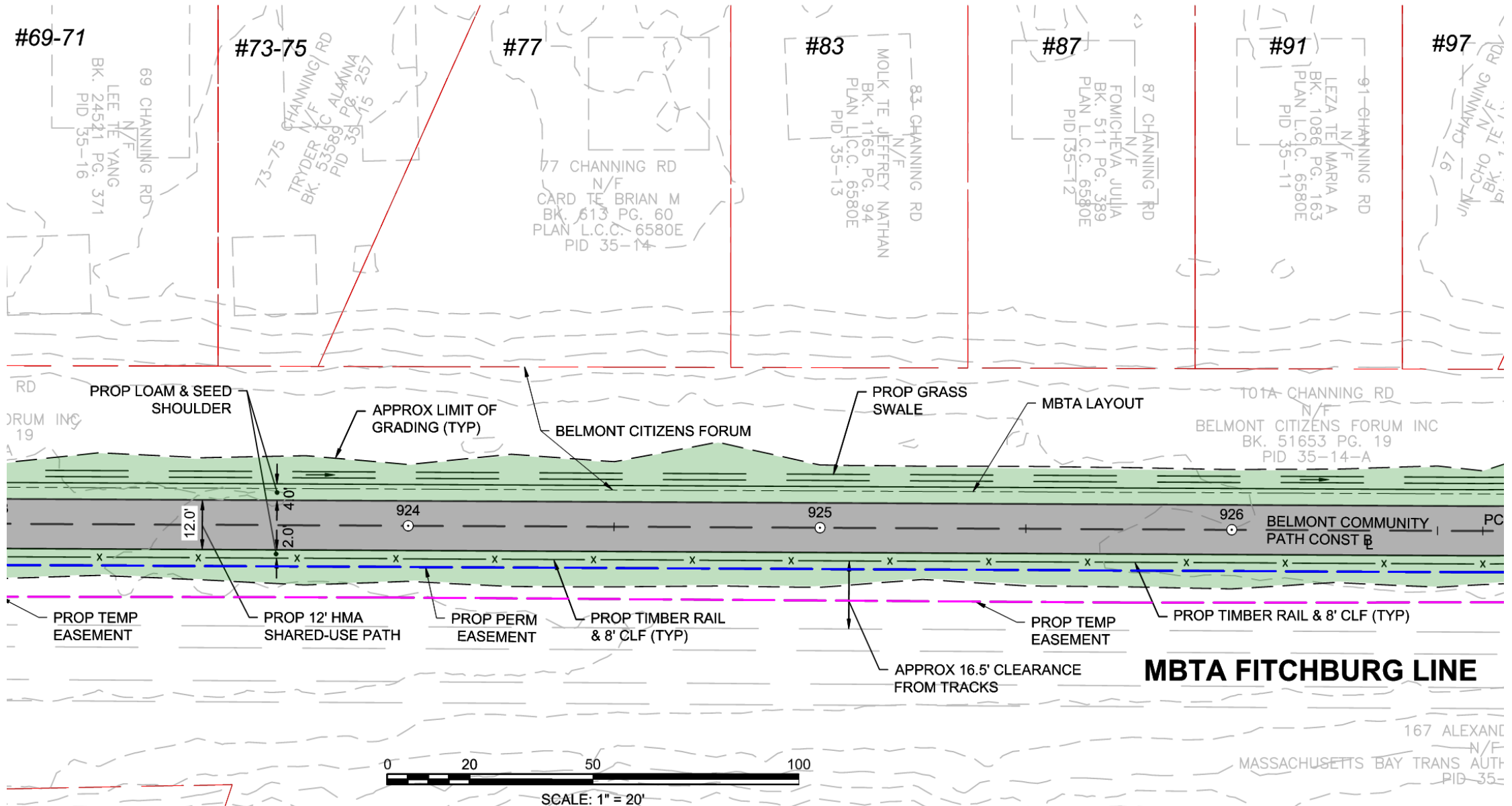

# Path Segment Between Concord Ave and Brighton St

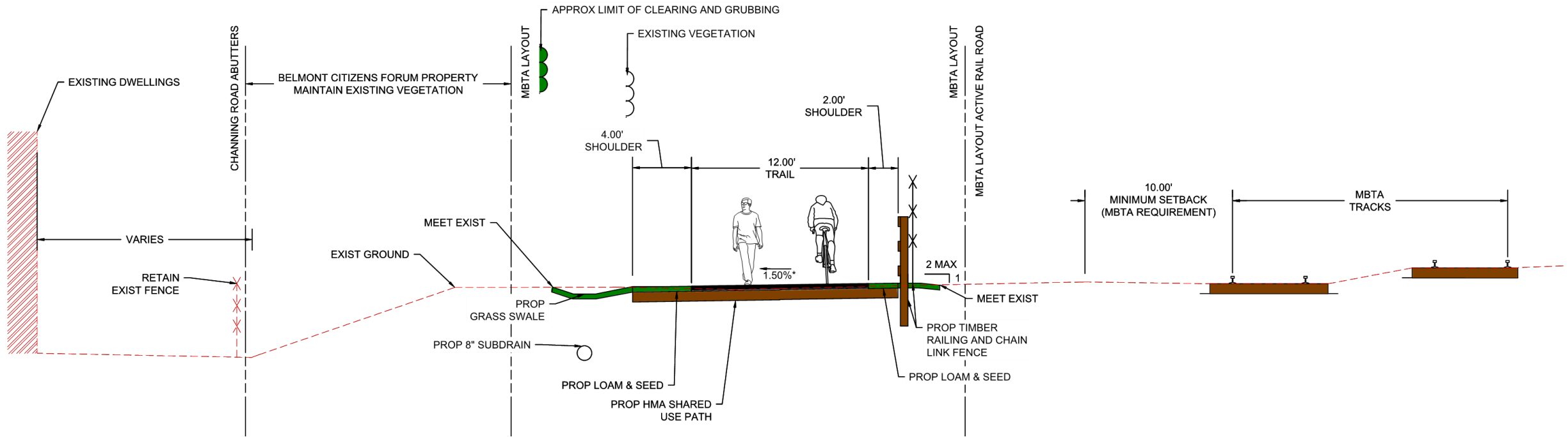

# Belmont Community Path – 35 Channing Road



Existing Photo: 35 Channing Road



Proposed Conditions: 35 Channing Road



Site Plan: 35 Channing Road



SECTION 3: 35 CHANNING ROAD  
SCALE: 1" = 10'-0"

# Belmont Community Path – 61 Channing Road



Existing Photo: 61 Channing Road



Proposed Conditions: 61 Channing Road



Site Plan: 61 Channing Road

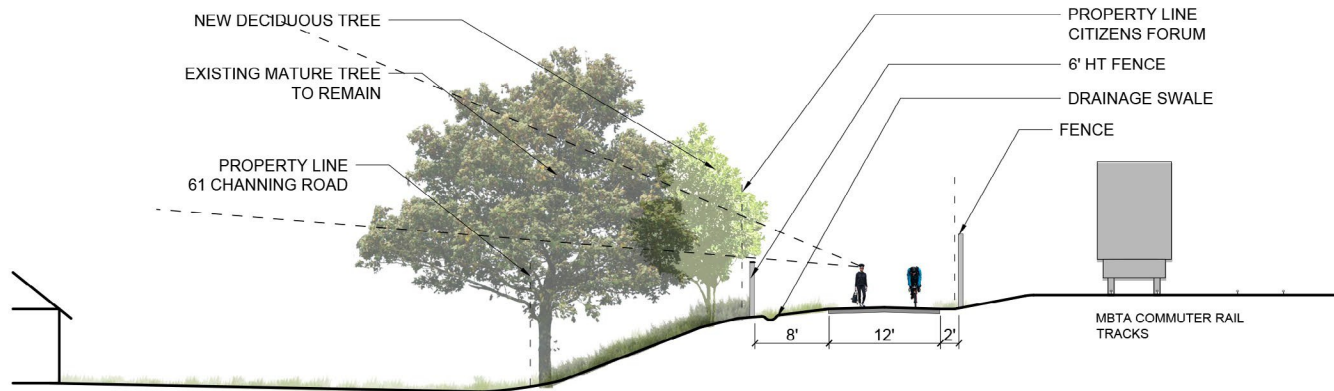

# Belmont Community Path – 119 Channing Road



Existing Photo: 119 Channing Road



Proposed Conditions: 119 Channing Road



Site Plan: 119 Channing Road

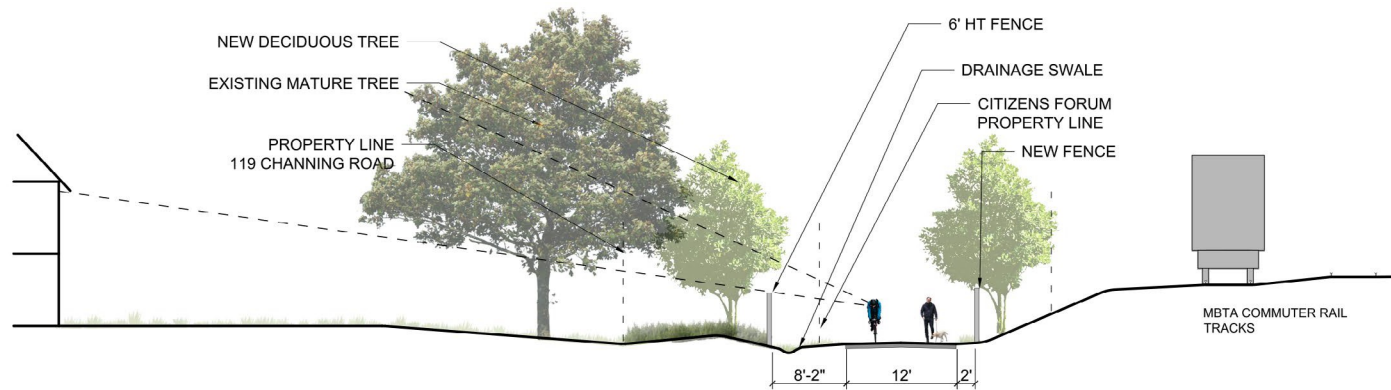

# Alexander Avenue Underpass

## CHANNING ROAD

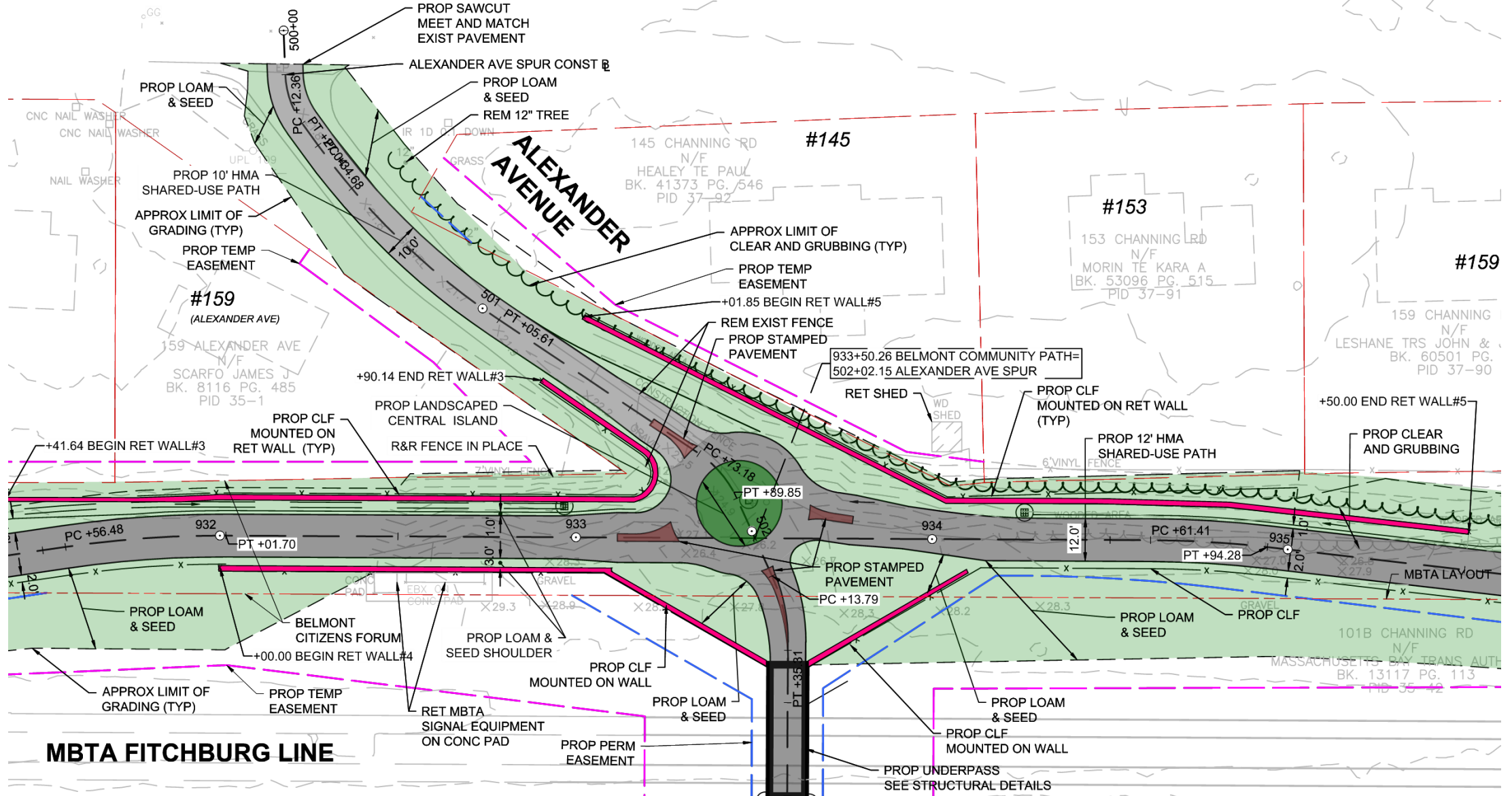

**MBTA FITCHBURG LINE**

PROP UNDERPASS  
SEE STRUCTURAL DETAILS



# Concord Ave Connection from Underpass

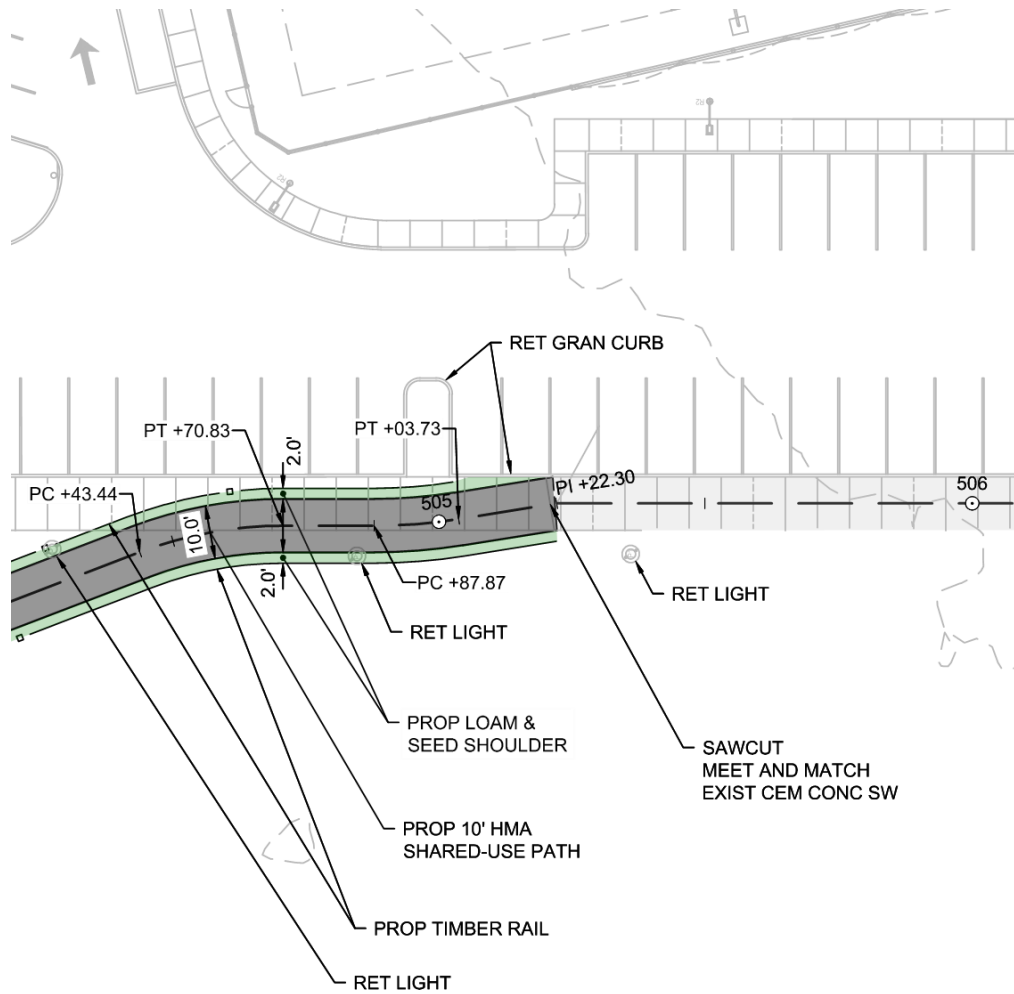

## BELMONT MIDDLE AND HIGH SCHOOL

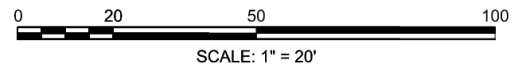
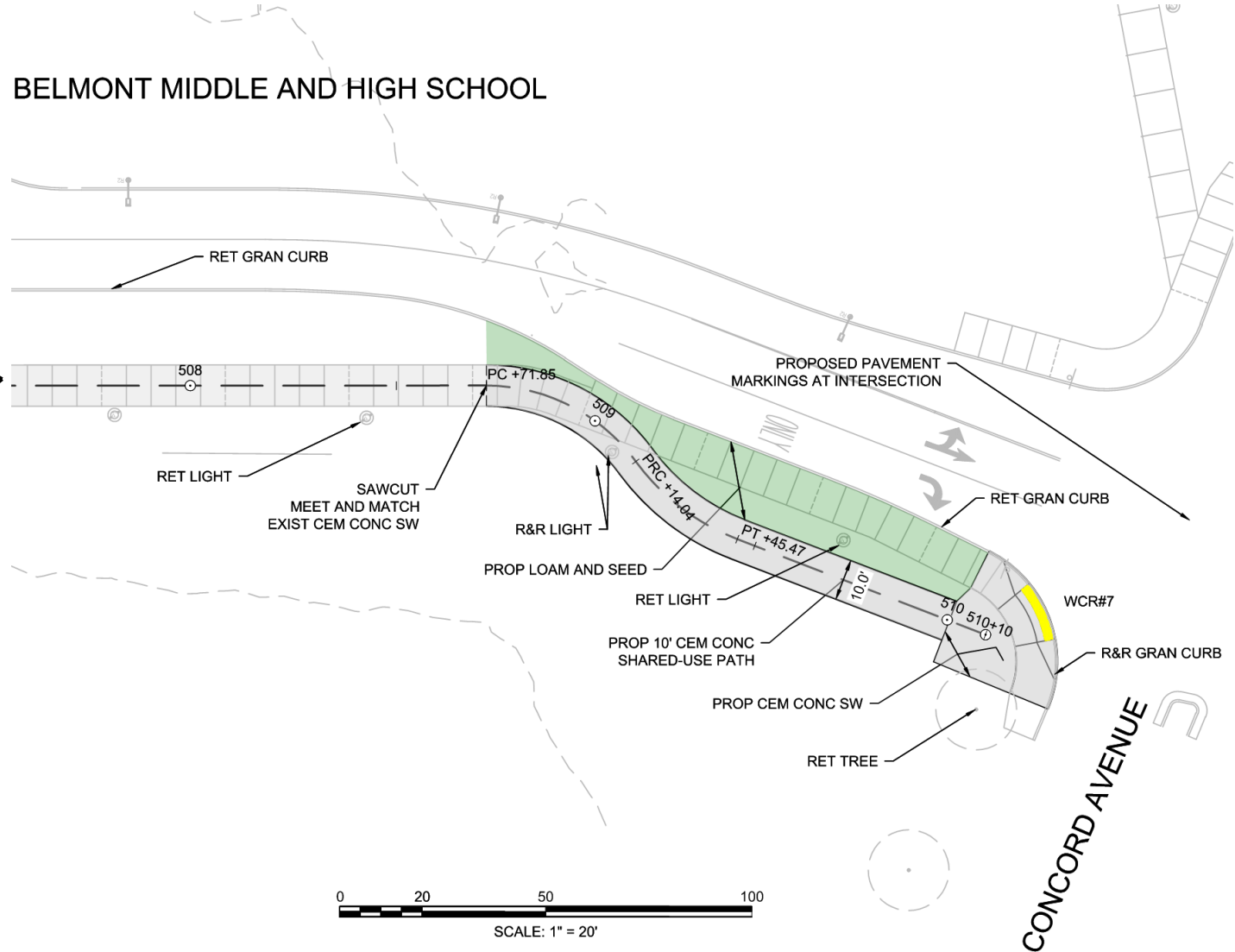

CONCORD AVENUE

# Belmont Community Path – Alexander Avenue Underpass



Site Plan: Alexander Avenue Underpass

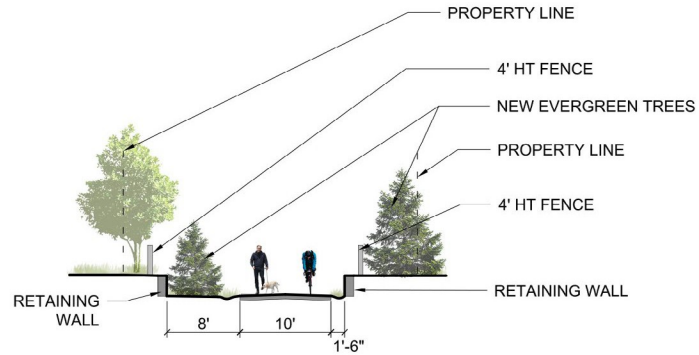

SECTION 9: ALEXANDER AVENUE CONNECTION  
 SCALE: 1" = 10'-0"

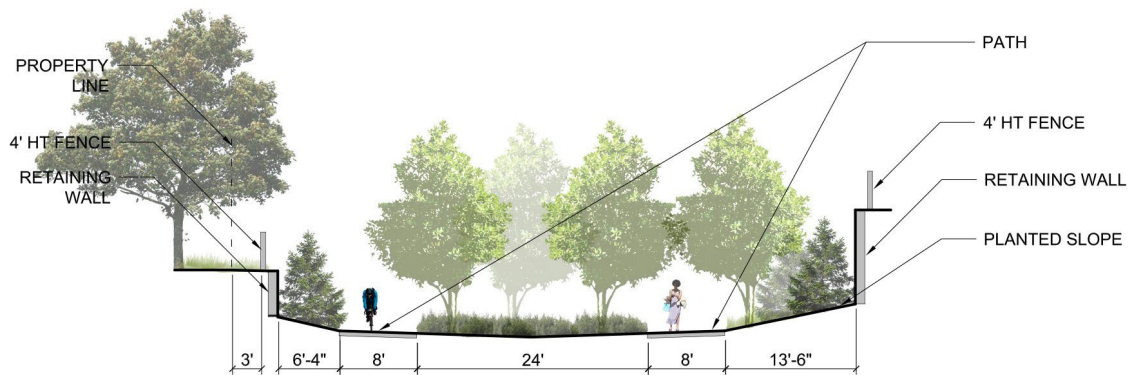

SECTION 10: ALEXANDER UNDERPASS AND COMMUNITY PATH JUNCTION  
 SCALE: 1" = 10'-0"

# Alexander Avenue Underpass

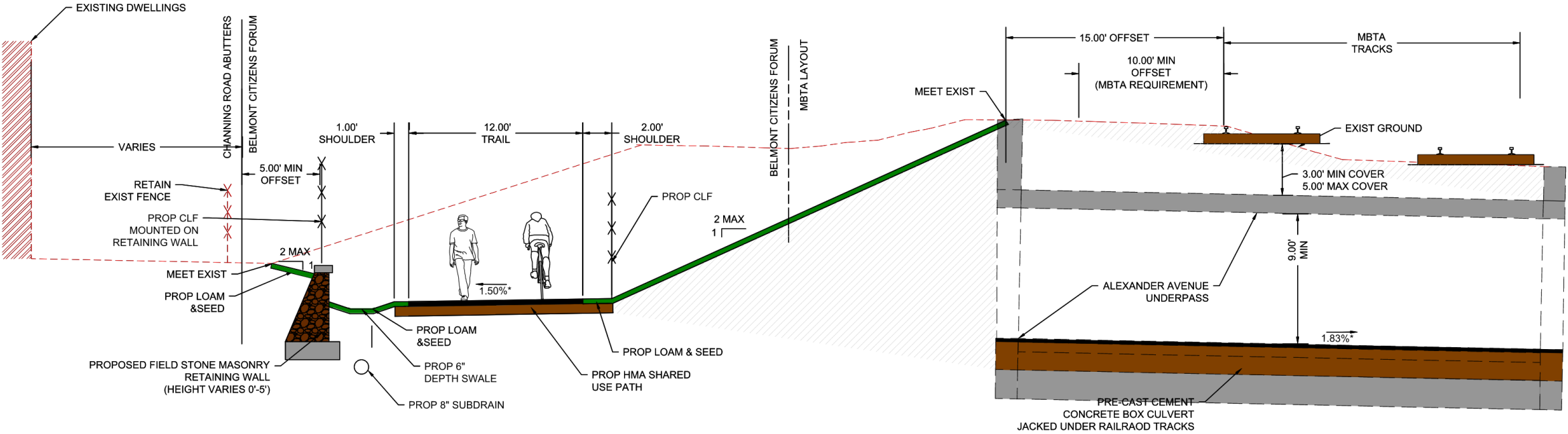

**BELMONT COMMUNITY PATH**  
 STA 931+42 TO 932+00  
 STA 934+10 TO 935+00  
 \*0.5%± TOLERANCE FOR CONSTRUCTION



# Alexander Avenue Underpass

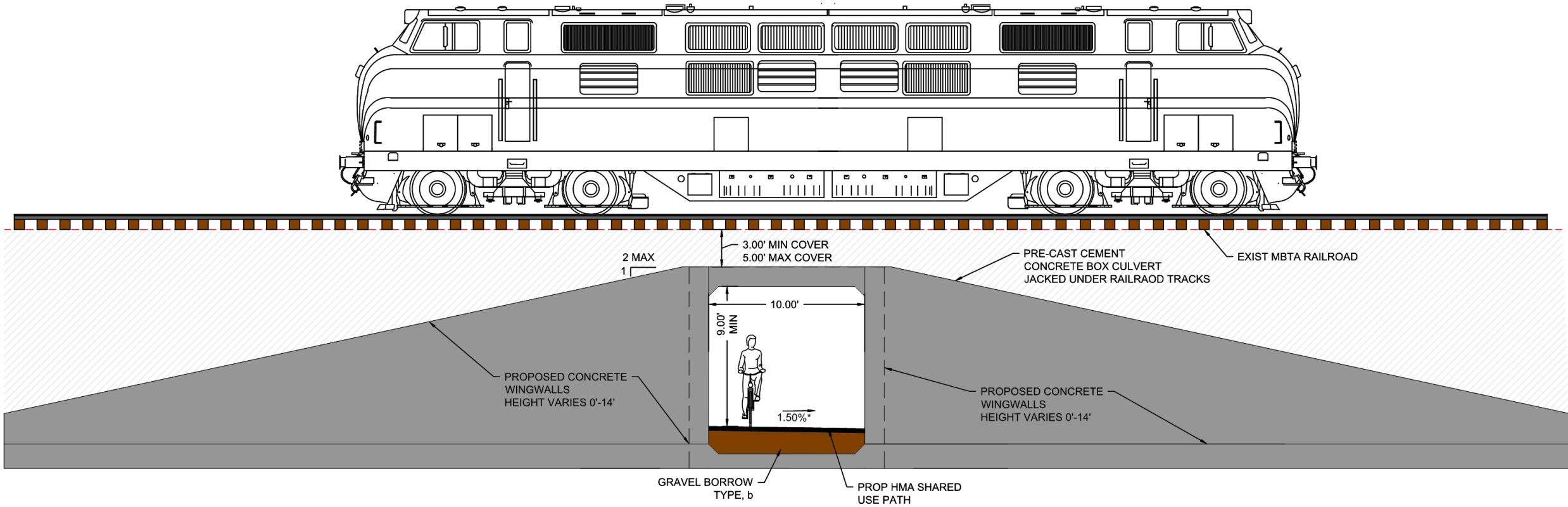

- 9 foot minimum height
- 3 foot minimum cover under railroad tracks
- Underpass Lighting





# Belmont Community Path – 167 Channing Road



Site Plan: 167 Channing Road

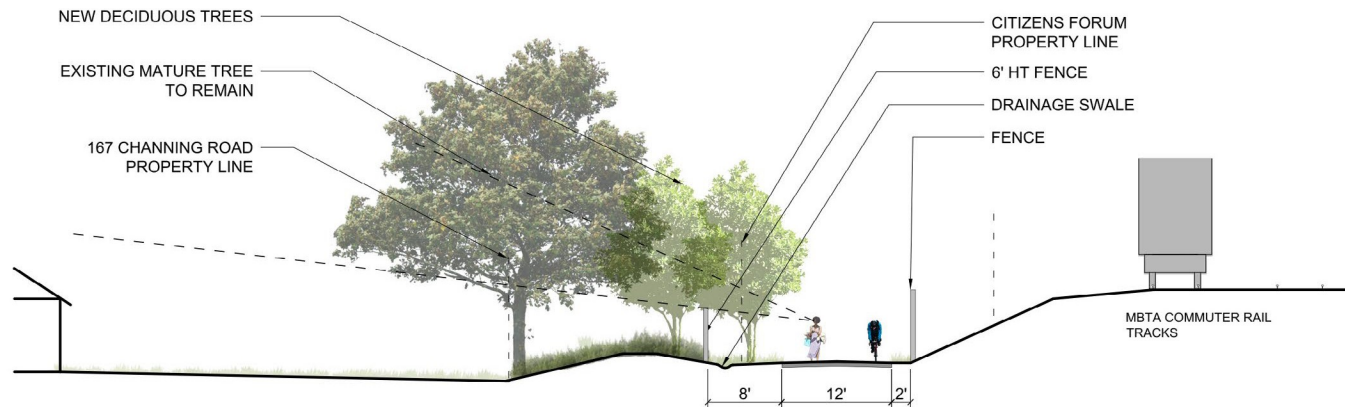

SECTION 6: 167 CHANNING ROAD  
SCALE: 1" = 10'-0"



# Belmont Community Path – 241 Channing Road



Existing Photo: 241 Channing Road



Proposed Conditions: 241 Channing Road



Site Plan: 241 Channing Road



SECTION 7: 241 CHANNING ROAD  
SCALE: 1" = 10'-0"

# Belmont Community Path – 271 Channing Road



Existing Photo: 271 Channing Road



Proposed Conditions: 271 Channing Road



Site Plan: 271 Channing Road

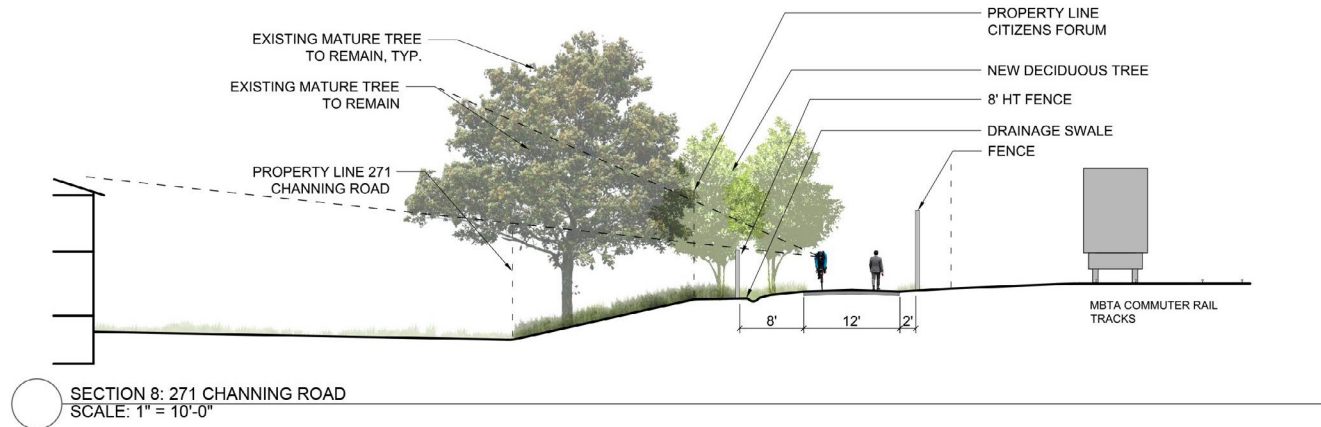

# 40-42 Brighton Street

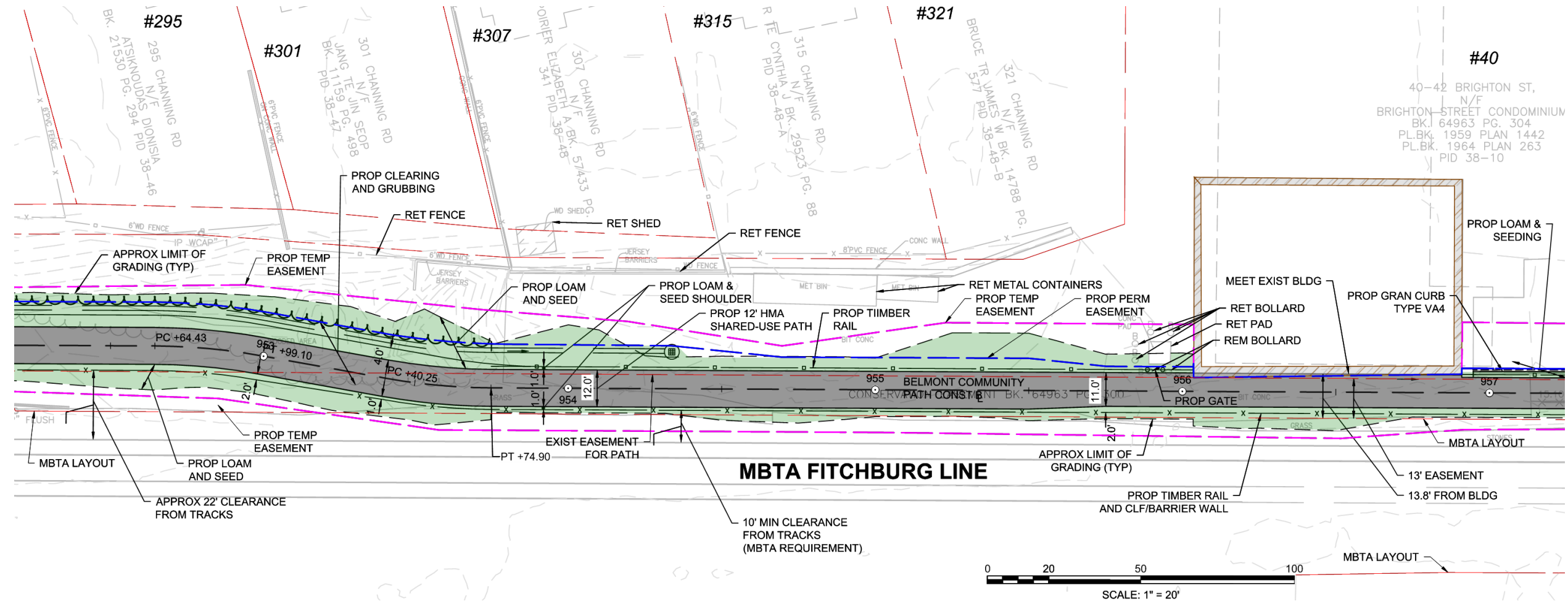

# 40-42 Brighton Street

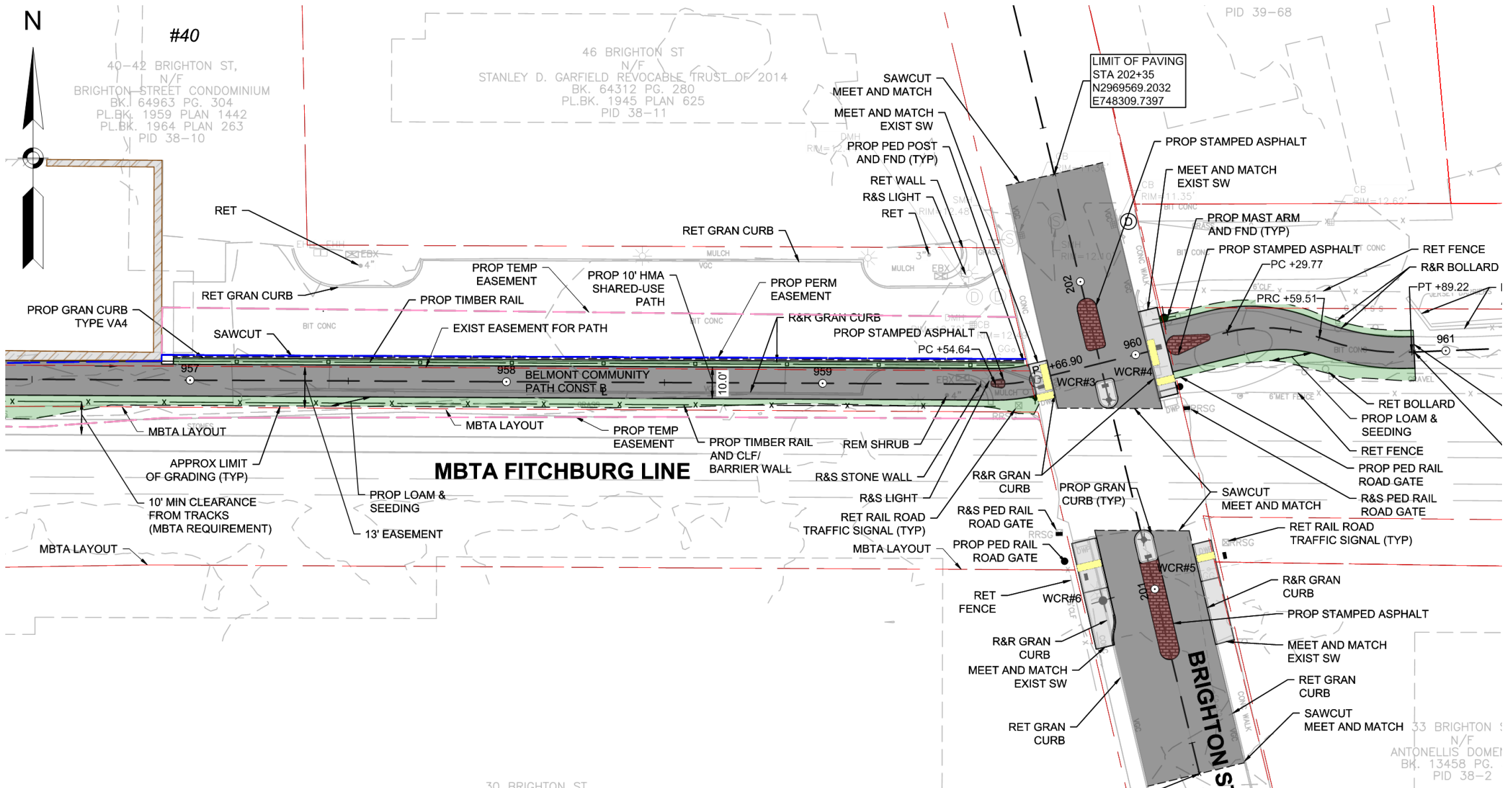

# Belmont Community Path – 40/42 Brighton Street

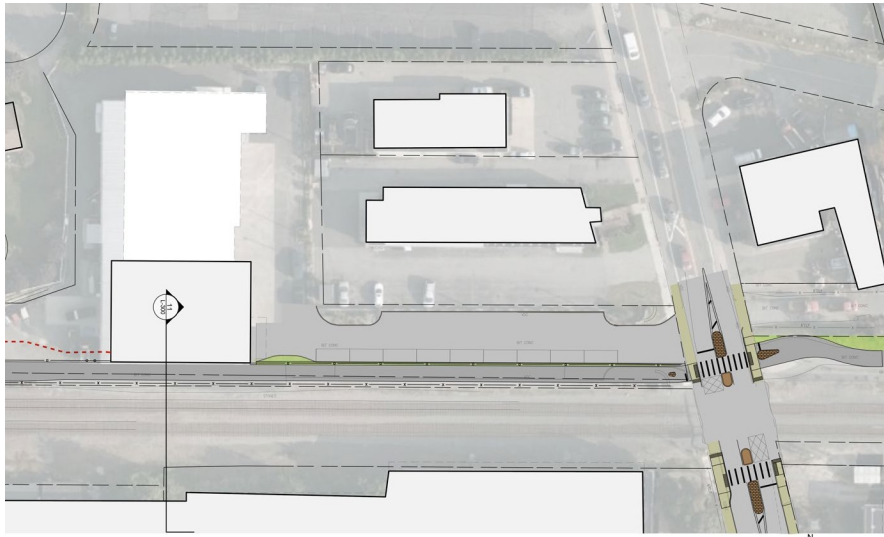

Site Plan: 40/42 Brighton Street



Existing Photo: 40/42 Brighton Street



Proposed Conditions: 40/42 Brighton Street

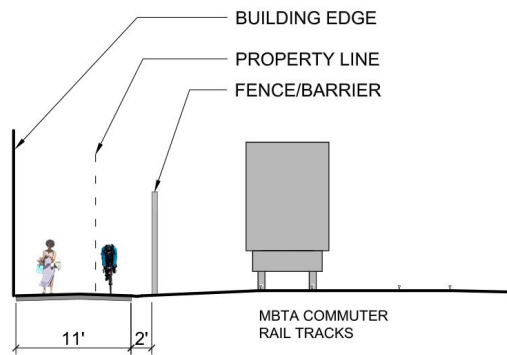

SECTION 11: 40/42 BRIGHTON ST.  
SCALE: 1" = 10'-0"

# 40-42 Brighton Street

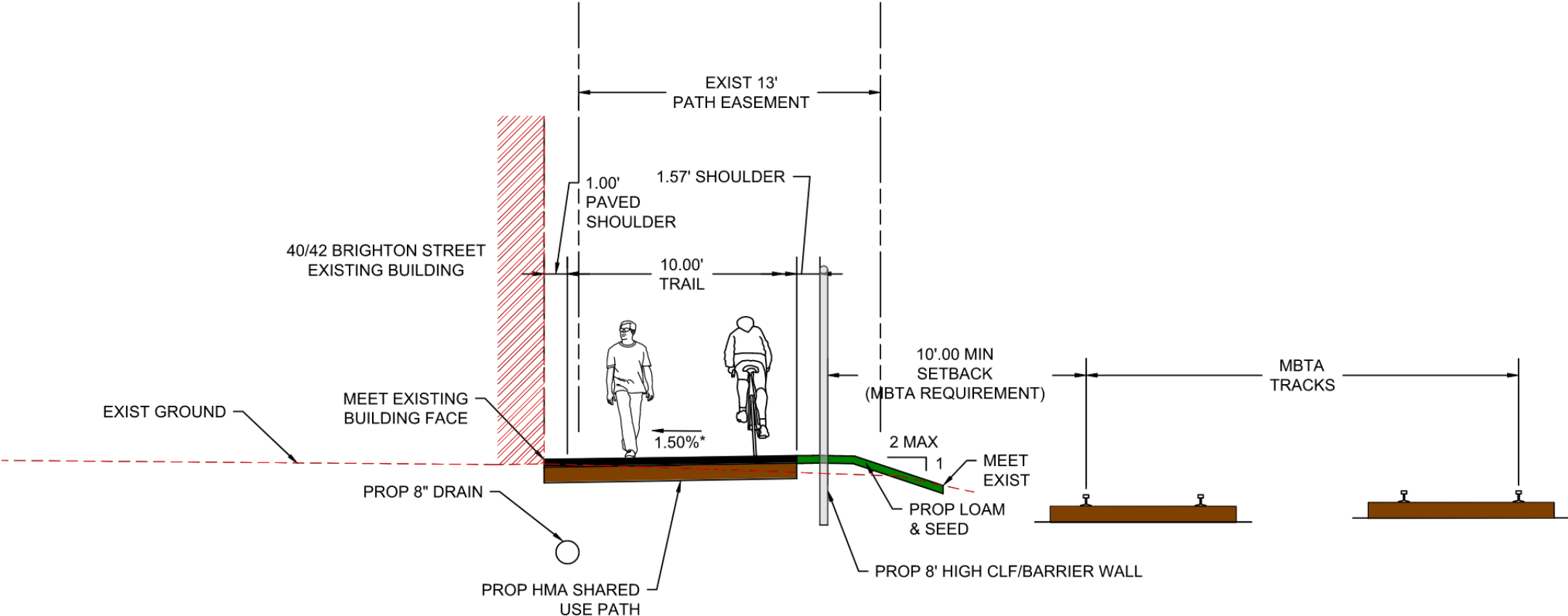

# Belmont Station/Clark Street Spur – Drainage



# Alexander Avenue Underpass – Drainage





# Brighton Street – Drainage



# Brighton Street – Vertical Barrier



Chain link fence with protective shield



Pre-fabricated wall – Fiberglass panels

# Project Scope

- 12-foot wide path conforming to ADA, FHWA, and MassDOT Requirements for shared use paths
  - 4-foot shoulder along north side
  - Drainage swale and sub-drain
- Underpass crossing railroad tracks providing connection to Concord Ave
  - Jacking operation ~3 weeks duration + 2 weeks of prep
  - ~\$4M including jacking pits and underpass structure
- Underpass lighting
- Improved safety at Brighton Street with new signal & gates
- Improved landscape and screening along corridor
- Landscaped Trailheads
  - Accessible connections to Pleasant Street, & Belmont Station
- Proposed Easements & coordination with MBTA/MassDOT
- Project Cost Estimated at ~\$20M

## Next steps

Action Item	Scheduled Timeframe
Review Public Comments	July 2020
Complete Soil Borings for Retaining Walls	2-3 Weeks
Submit 25 % Design to MassDOT	Summer/Fall 2020
MassDOT Review of 25% Design	Fall/Winter 2020
Design Public Hearing	Winter 2020

# Questions/Comments

- If you want to speak during the meeting, please raise your hand and you will be permitted to ask your question or make a comment.
- Preferred means to provide comments:
  - Please submit comments on the project website at [www.belmontcommunitypath.com](http://www.belmontcommunitypath.com)
  - We invite you to take our preliminary design survey on the project website at [www.belmontcommunitypath.com](http://www.belmontcommunitypath.com)
  - Survey will be open until 7/31.



**Stay informed: Sign up for blog updates and announcements:**

*www.Belmontcommunitypath.com → subscribe for updates*